

LEGEND

- 1 TERRACE AND EXISTING PLAYGROUND
- 2 MULTIPURPOSE / GYMNASIUM
- 3 FOYER
- 4 STORAGE
- 5 SHOE RACKS
- 6 REMOVABLE STAGE
- 7 EQUIPMENT CLOSET
- 8 MIMBER AND MEHRAB
- 9 RETRACTABLE BLEACHERS
- 10 WALL MOUNTED FOLDAWAY DINING TABLE
- 11 VOLLEY BALL COURT
- 12 FULL SIZE TRAINING BASKETBALL COURT
- 13 FULL SIZE CEREMONIAL BASKETBALL COURT
- 14 FOLDING PARTITIONS
- 15 PRAYER LINES
- 16 GIRLS LOCKERS / STORAGE
- 17 FOOD SERVICE
- 18 BOYS LOCKERS / STORAGE
- 19 GYMNASIUM SUPPORT
- 20 HALLWAY WITH LOCKERS
- 21 FIRE CONTROL
- 22 WATER SERVICE / UTILITY
- 23 ELECTRICAL
- 24 I.T.
- 25 STAIRS
- 26 CLASSROOMS
- 27 SEMINAR/ LECTURE ROOMS (DIVIDABLE)
- 28 OPTIONAL SLOPED FLOOR AUDITORIUM
- 29 STUDENTS BREAK AND STUDY ROOM
- 30 VENDING AREA
- 31 ACCESS TO THE EXISTING BUILDING
- 32 EXISTING ELECTRICAL ROOM
- 33 EXISTING ROOM CONVERTED TO ELECTRICAL
- 34 EXISTING ROOM CONVERTED TO ELECTRICAL
- 35 EXISTING MULTIPURPOSE HALL CONVERTED TO LIBRARY / MEDIA CENTER IN FUTURE
- 36 DROP OFF CANOPY
- 37-50 NOT USED
- 51 HALLWAY OVERLOOKING GYM BELOW
- 52 JANITOR
- 53 STORAGE
- 54 OFFICE
- 55 GIRLS RESTROOM
- 56 BOYS RESTROOM
- 57 LAB
- 58 SCIENCE ROOM
- 59 PREPARATION ROOM
- 60 SCIENCE LAB
- 61 OPEN TO BELOW
- 62 FUTURE CONVERSION OF EXISTING ROOM TO OFFICE
- 63 FUTURE LAB / CLASSROOM
- 64 FUTURE LAB / CLASSROOM
- 65 FUTURE EXPANSION OF EXISTING COMPUTER LAB
- 66 FUTURE EXPANSION OF EXISTING SCIENCE LAB

COLOR LEGEND

- PHASE 2 INTERIM GYM & HALLWAYS
- PHASE 2 FUTURE FINISH OUT
- EXISTING BUILDING TO REMAIN
- FUTURE REMODELING IN THE EXISTING BUILDING

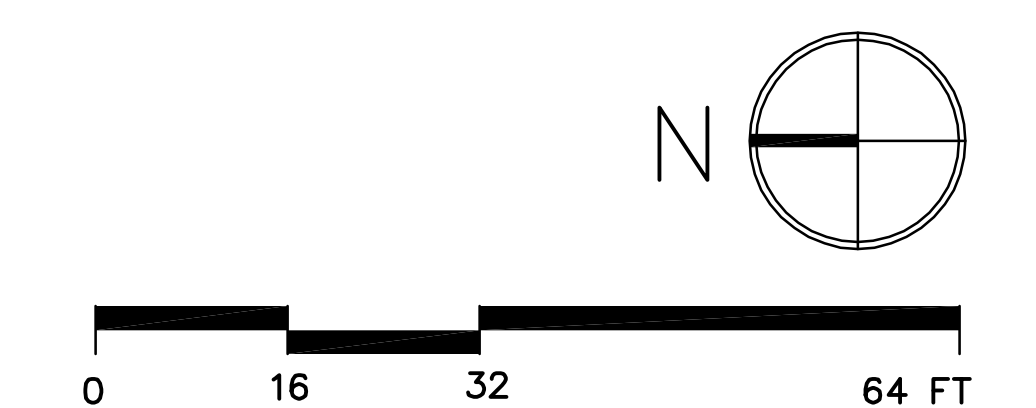
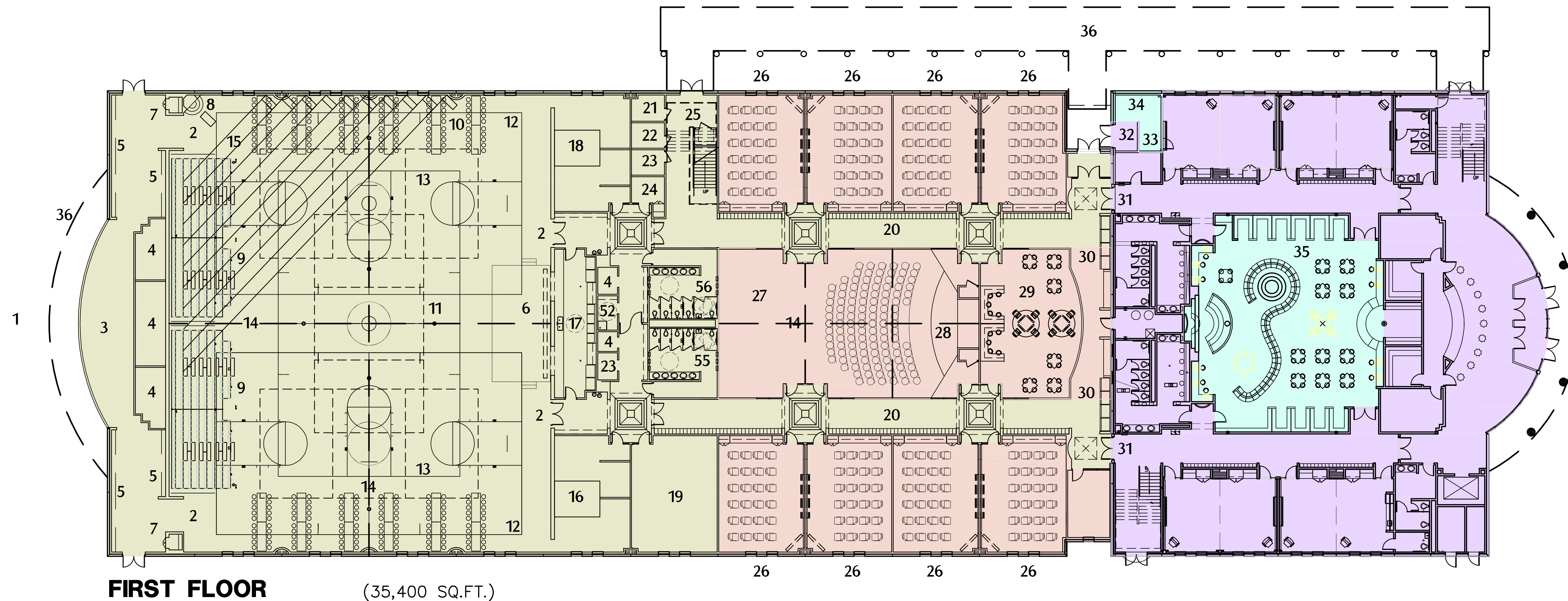
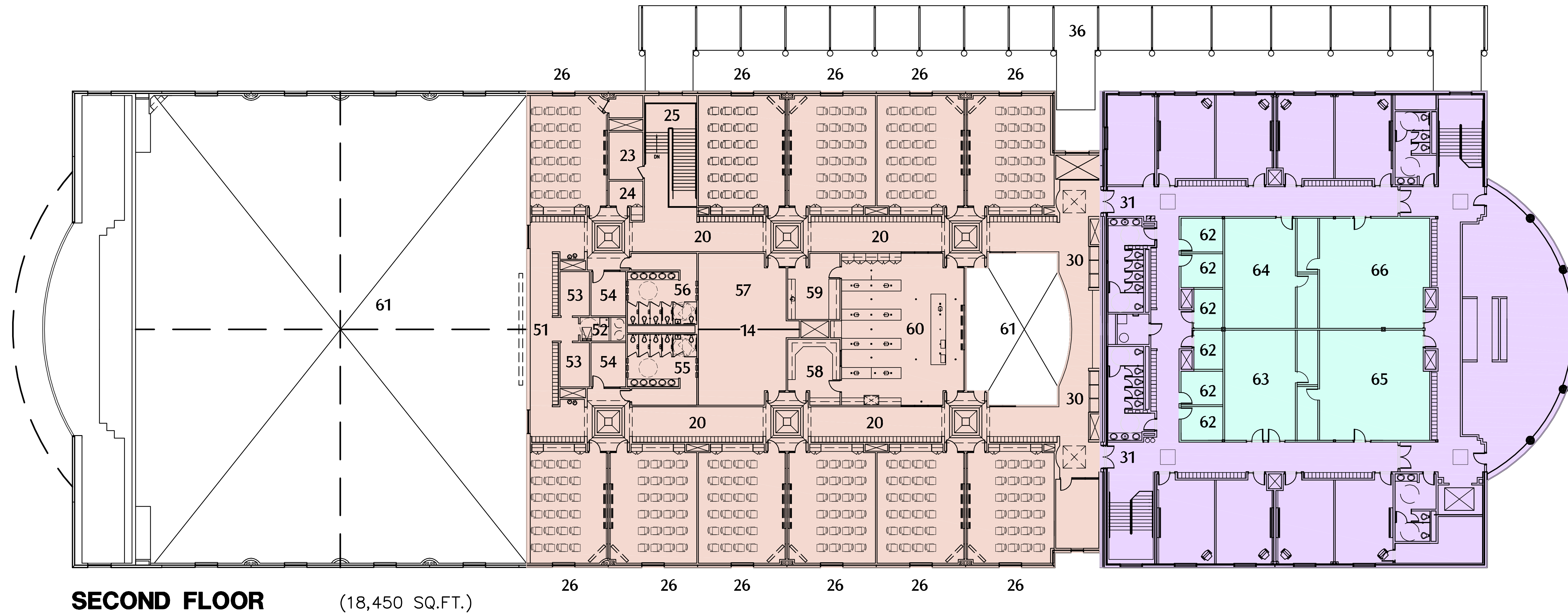

MARCH 05, 2011